

**Disconnected**

**Connected**

1-85-006-2-00000-...-Z01

**Pallet side**

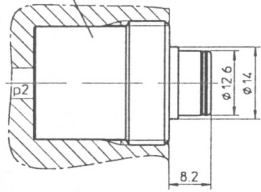

1-85-006-0-00000-...-Z01

**Machine side**

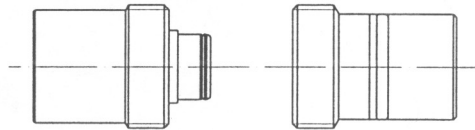
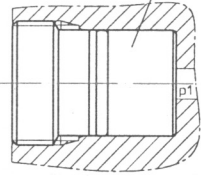

1-85-006-2-00000-...-Z01

**Pallet side**

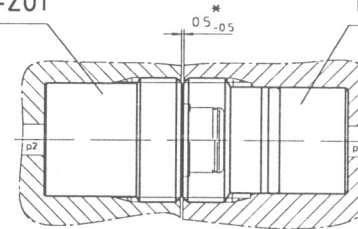

1-85-006-0-00000-...-Z01

**Machine side**

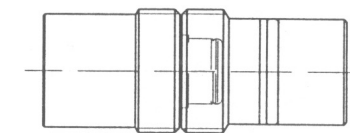

1-85-006-2-00000-...-Z01

**Installation space for :**

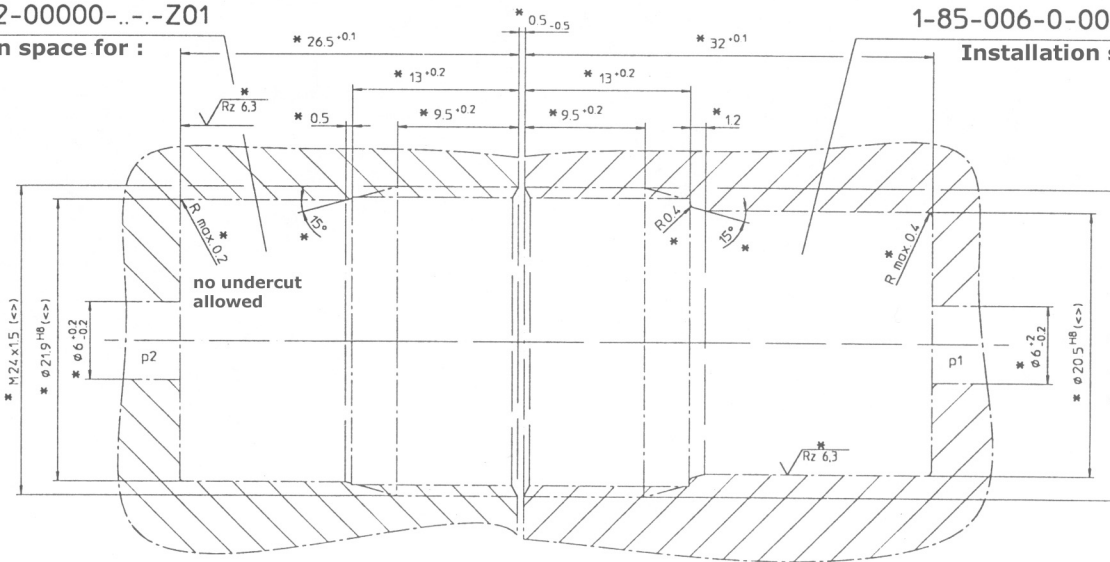

1-85-006-0-00000-...-Z01

**Installation space for :**

Assembly dimensions and surfaces which are needed by customer are marked with \*.

Maximum angular misalignment: +/- 0.15°  
Maximum radial misalignment: +/- 0.3mm

	Material and seal code	Working Pressure (psi)			Max differential press. for connect/disconnect	
		Connected	Dis-connected	During connection	p2 - p1 (p1 = 0)	p1 - p2 (p2 = 0)
VK	AAAA	3480	3480	870	870	580
VN	AAAB	3480	3480	870	870	580
VK						
VN						

	1-85-006-0-00000-...-Z01			
	1-85-006-2-00000-...-Z01			
2.1 Fertigungs- und Prüfverfahren nach WALTHER Werkstaub-Nr. 52100.93	Ersatz für 1-85-006-0-00000-...-Z01 Ausführung D vom 31.01.2000 KS A 04846	Datum 11.11.1999 Gezeichnet 11.11.1999	Name KS HJKL	1-85-006-0-00000-...-Z01 1-85-006-2-00000-...-Z01
CAD-Zeichnung nicht manuell ändern! <b>85 Series Coupling Mounting</b>				